

N-Series Superior Night Vision 3 Megapixel Vandal Dome Network Camera

VD-300N Series

HDTV 1080p/720p • 3M/2M/1.3M Resolution Supported



- N-Series Sony Exmor™ 3M Vandal Dome Camera
- **SmartFocus®** to Ease the Zoom and Focus Adjustment Remotely
- Support HDTV Video Quality (Full HD 1080p @ 30fps Streaming)
- Brickcom **WDR Enhancement®** technology inside
- MPEG-4, MJPEG and H.264 Triple Codec Compression
- **Intelligent Multi-Profile Sensor Management®** for Different Environments
- Removable IR-cut Filter /Auto Light Sensor for Day and Night
- 1 DI/DO for External Alarm and Sensor Device
- 3 Axis design
- Two-way Audio/Built-in SD/SDHC Memory Card Slot for Local Storage
- IK10 Vandal Proof and IP67 Weather Proof Outdoor Enclosure
- Power over Ethernet/DC 12V/AC 24V support
- Smart IR to adjust the IR LED light across the entire area to get a well illuminated image



ONVIF

Photo Indication & Dimension Diagram

VD-300Np

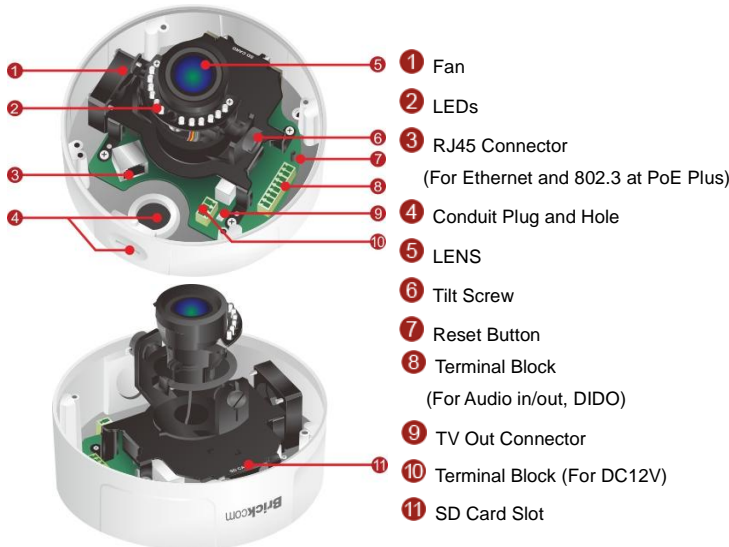

VD-300Np V5

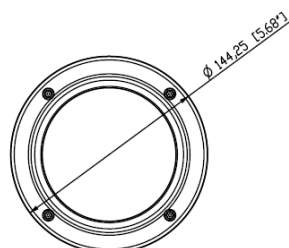
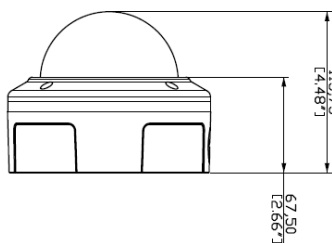
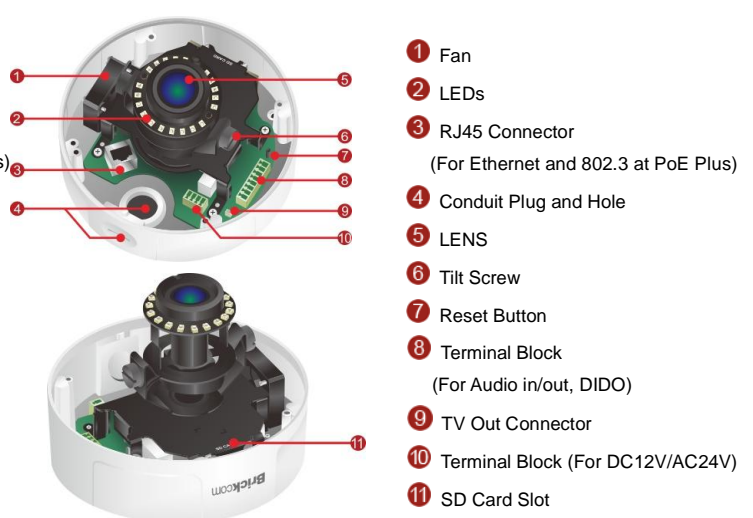

Camera	
Models	3M, Motorized Lens, Smart Focus
Hardware System	CPU: 533 MHz Flash: 32M RAM: 256M DDR
Image Sensor	Sensor Type : 1/2.8" Sony Exmor TM CMOS Sensor Sensor Resolution : 2048x1536 pixel
Minimum Illumination	0 lux (IR ON, B/W) 0.008 lux (IR OFF, B/W) 0.01 lux (F1.4, Color)
IR Illuminators	VD-300Np Built -in IR Illuminators, effective up to 15 meters IR LED: 12pcs IR wavelength: 850nm VD-300Np V5 Built -in IR Illuminators, effective up to 25 meters IR LED: 20pcs IR wavelength: 850nm
Lens	Lens Type: Board Lens F No.: 1.4 Focal Length: f= 3mm(W)~10.5mm(T) View Angle: (H): 92°~32°/ (V): 68°~27°/ (D):114°~40°
Day & Night ICR	Triggered by Light sensor, Scheduling, Digital Input
Local Storage	Built-in SD/SDHC/SDXC Max.64G Memory Card Slot
Video	
Compression Streaming	H.264 / MPEG4 / MJPEG Simultaneous multiple streams
Video Setting	Multi-Profile Image Management: Day/ Night/ Sunset/ User 1/ User 2 Auto Exposure Control Manual Exposure Control: 1/10000~1/5s Manual Gain Control: 1X ~ 32X Manual White Balance Control: 2000K~7000K
S/N Ratio	>50 dB
Image Resolution	3M : 2048x1536 @ 20fps 2M (Full HD) : 1920x1080 @ 30fps 1M : 1280x720 @ 30fps

Events and Alarm Management	
Events	Motion Detection/ Schedule/ Audio Detection/ Digital Input/ Temperature Alarm(*)/ Auto Focus Shift for Day & Night(*) *VD-300Np V5 Only
Alarm	Stream/Snapshot to FTP/Email/Samba/SD-Card HTTP/Email Notification/ Digital Output

Audio	
Audio Streaming	2-way Audio Support
Audio Compression	G.711, AMR (8 kHz, Mono, PCM)
Audio Input/ Output	Line In/ Out
General	
Communication	Ethernet : one 10/100Mbps RJ-45 Supported Protocols : TCP/IP, UDP, ICMP, DHCP, NTP, DNS, DDNS, SMTP, FTP, HTTP, Samba, PPPoE, UPnP, RTP, RTSP, RTCP, IPv6
Power Input/ Operating Temperature	VD-300Np 802.3 af POE/ DC12V 1A -20°C ~ 60°C (-4°F ~140°F) 802.3at PoE Plus(built in fan and heater): -40°C ~ 60°C (-40°F ~140°F) VD-300Np V5 802.3 af POE/ DC12V 1A /AC 24V: -20°C ~ 60°C (-4°F ~140°F) 802.3at PoE Plus(built in fan and heater): -40°C ~ 60°C (-40°F ~140°F)
Max. Power Consumption	DC12V 1A VD-300Np :10 Watts DC12V 1.5A/AC 24V VD-300Np V5 :12.5 Watts 802.3 af POE VD-300Np :12.5 Watts/ VD-300Np V5 :15 Watts 802.3at PoE Plus VD-300Np : 25 Watts/ VD-300Np V5 :27.5 Watts
Environment	Water Proof: IP67 Operating Humidity : 10% ~ 80%
Dimension	113.75 (D) mm X 144.25(H) mm
Weight	860g/1.90lb
Housing	Weather-proof (IP67) Vandal-proof (IK10)
Certification	FCC, CE, IK10
Viewing System Requirements	OS: Microsoft Windows 8/7/Vista/XP/2000 Browser: Mozilla Firefox, Internet Explorer 7/8 or above, Safari, Google Chrome Cell Phone: 3GPP player Real Player: 10.5 or above Quick Time: 6.6 or above VLC
Warranty	VD-300Np : Limited 2-year warranty VD-300Np V5 : Limited 3-year warranty

Work Best With

Camera Accessories Options



L-WM-01
Camera Bracket



POE30U *
High Power PoE Injector



WPC *
Waterproof Connector

Network Equipment Options



PS-588I-v2
8-port 10/100M PoE Fast Ethernet Switch



PS-7242IL-AT
24-port 10/ 100M High Power PoE+ Web
Smart Ethernet Switch